

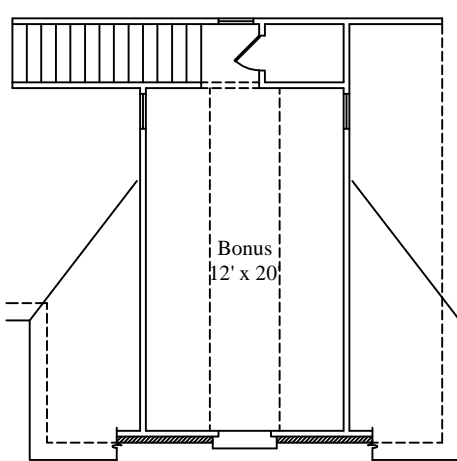

# The Ultimate Chadwick

Bonus @ Maitland Meadows

## Floor Plan

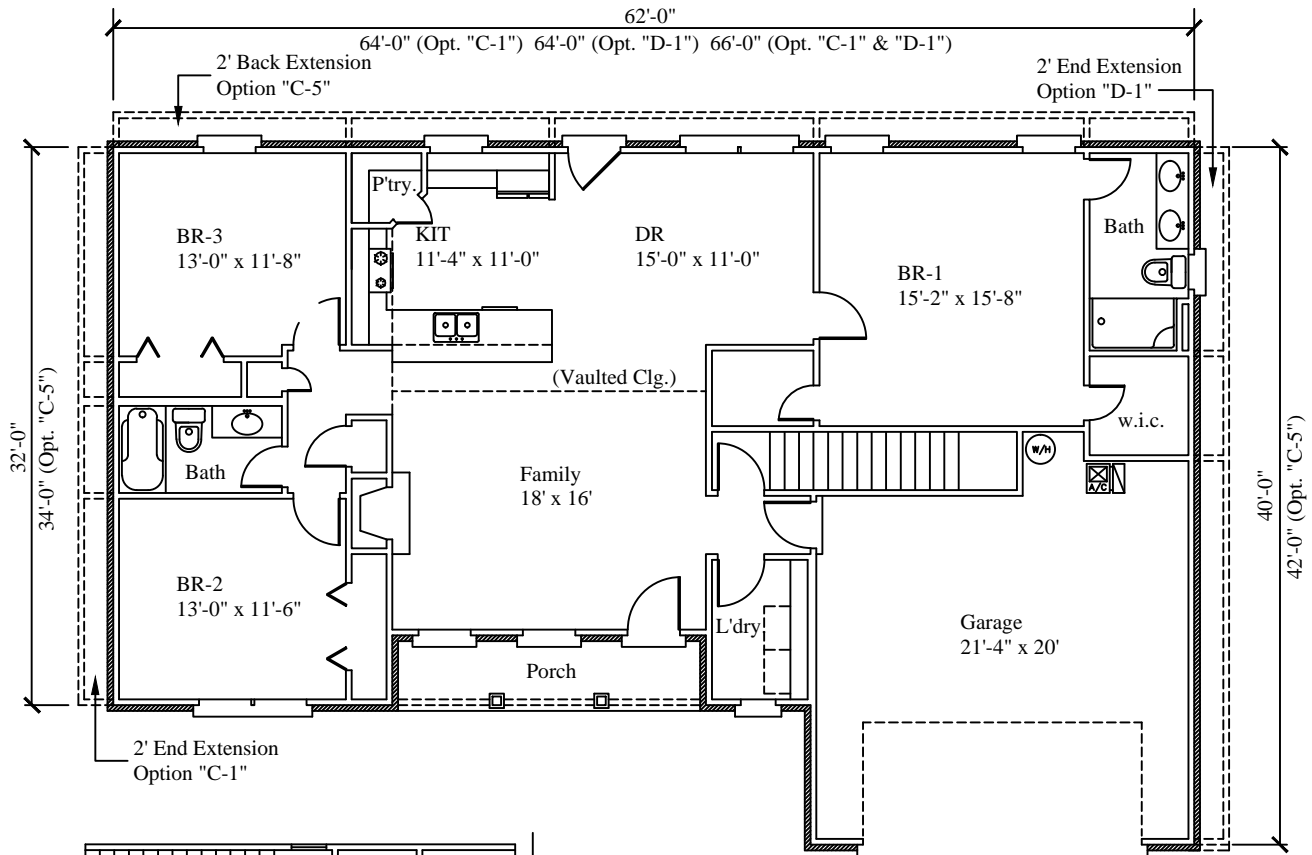

All dimensions are from outside framing to C/L of partitions - Actual dimensions may vary slightly from plans & models

### Base Model Includes:

Three-Bedrooms, Two Baths

1622 Sq. Ft. Living Area

240 Sq. Ft. Bonus Area

1862 Sq. Total Sq. Ft. (May Increase w/ Options)

466 Sq. Ft. Garage Area (2328 Total Sq. Ft.)

\* See SELECTION/OPTION SHEET for all available options and pricing

For Information, Call **Worley Builders, Inc., Realtors<sup>®</sup>**

**(865) 922-2600**

Visit Online: [www.worleybuildersinc.com](http://www.worleybuildersinc.com)