

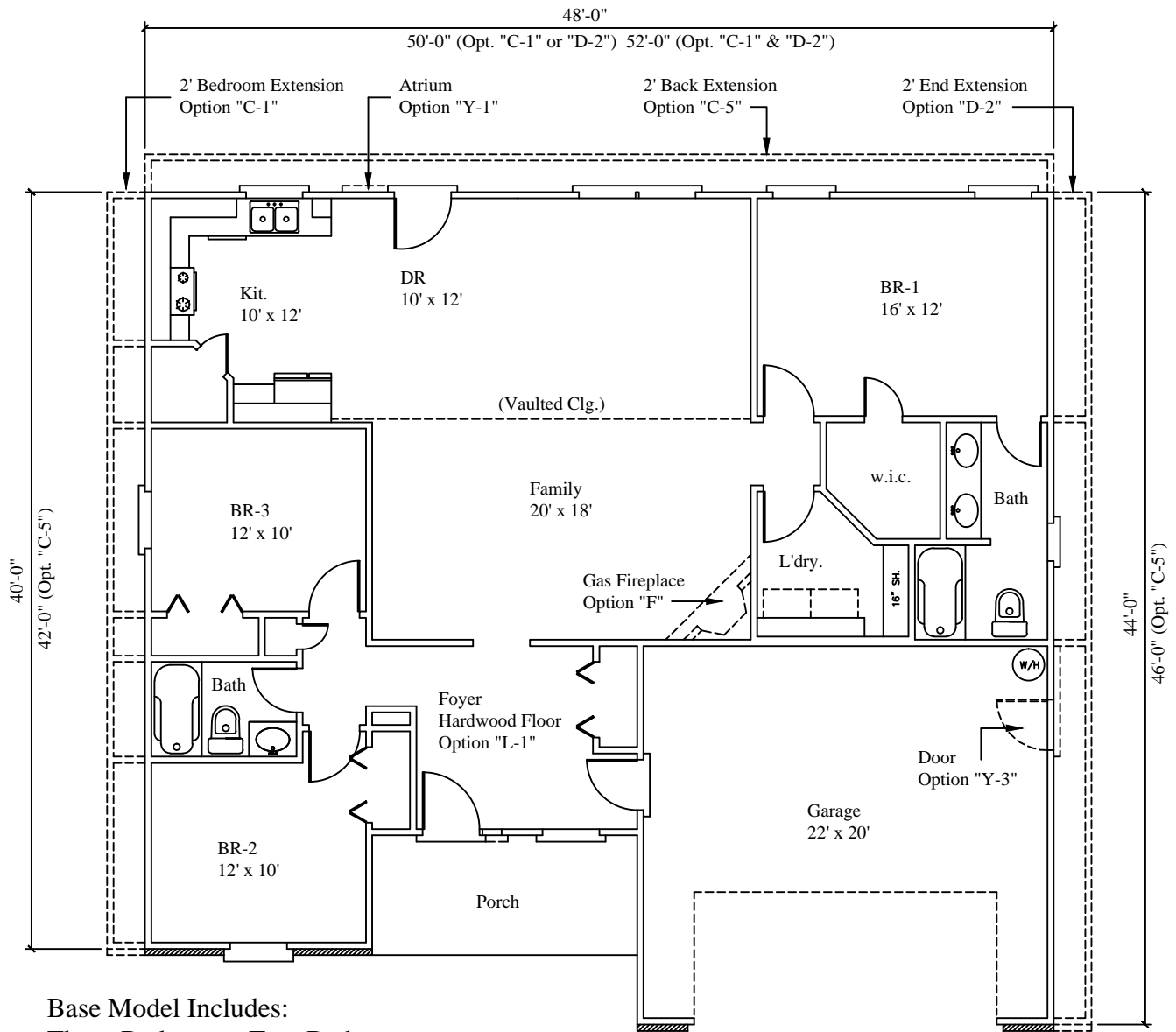

The Ashworth



Floor Plan



Base Model Includes:

Three-Bedrooms, Two Baths

1496 Sq. Ft. Living Area

440 Sq. Ft. Garage Area

1936 Total Sq. Ft. (May Increase w/ Options)

All dimensions are from outside framing to C/L of partitions -
Actual dimensions may vary slightly from plans & models

* See SELECTION/OPTION SHEET for all available options and pricing

For Information, Call **Worley Builders, Inc., Realtors®**

(865) 922-2600

Visit Online: www.worleybuildersinc.com