



# The Westbrook

@ Sparks Meadow



## Floor Plan

\* See SELECTION/OPTION SHEET for all available options and pricing

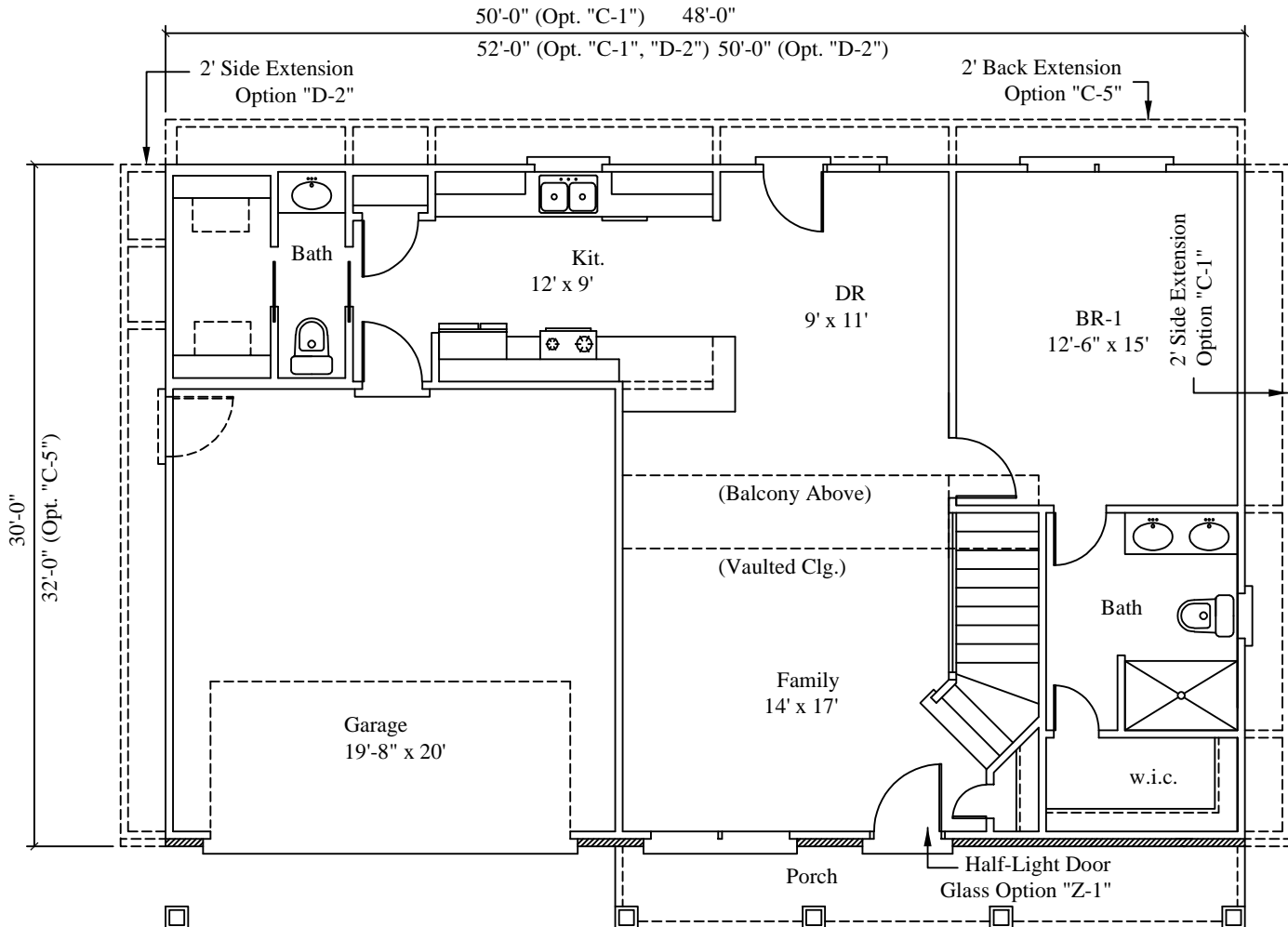

Base Model Includes:  
3-Bedrooms, 2.5- Baths  
1033 Sq. Ft. Living Area Main Floor  
761 Sq. Ft. Living Area Upper Floor  

---

1794 Sq. Ft. Total Living Area  
406 Sq. Ft. Garage Area  

---

2200 Total Sq. Ft.  
(May Increase w/ Options)

All dimensions are from outside framing to C/L of partitions -  
Actual dimensions may vary slightly from plans & models

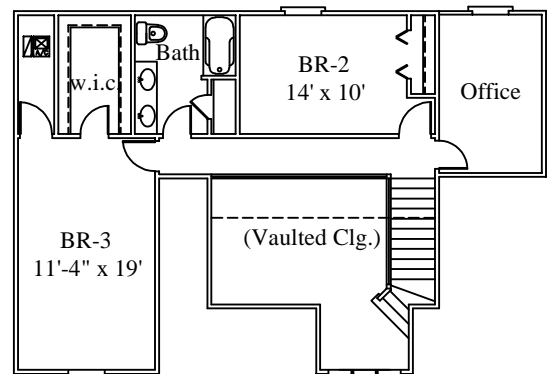

\* See SELECTION/OPTION SHEET for all available options and pricing

For Information, Call **Worley Builders, Inc., Realtors®**  
(865) 922-2600  
Visit Online: [www.worleybuildersinc.com](http://www.worleybuildersinc.com)